

Cavi60

MWR 200

- One hour fire rated barrier
- Acoustic barrier
- Friction fit or upstand flap fit
- Cavity width up to 200mm

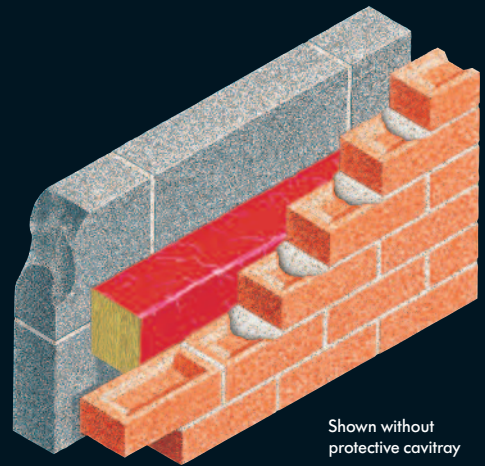

Shown without protective cavity trays

REQUIREMENT

To provide 1 hour fire rated acoustic cavity stop for use in wider cavity walls in intermediate and top of wall locations.

SOLUTION

This is a larger version of the Type CFIS and accommodates cavities from 100mm up to 200mm. The Cavi 60 prefix denotes one hours fire rating. The insulating core promotes acoustic suppression. Thus this model can be used to address both fire and sound barrier requirements.

This product can also be supplied with an upwardly extending flap on one side of the encapsulation. This provides an alternative fixing option of securing to the inner skin should this be required. State clearly which version is required.

REFERENCES

- BS 476 (fire resistance testing)
- Part E details – resistance to the passage of sound
- Building Regulations Document C L1 & L2
- Scottish Tech Standards Part D
- Robust Details

- PD6697:2010
- BRE Thermal Insulation Avoiding Risks

SPECIFY

Cavi 60 MWR 200 Cavichex Fire Integrity Stop by Cavity Trays of Yeovil Somerset BA22 8HU (01935 474769).

to suit cavity width ofmm supplied with / without encapsulation flap. (delete as required). Compress and friction fit within cavity and/or secure to inner skin utilising upstand flap following all accompanying instructions. Overlap adjoining lengths to maintain protection integrity. Specify if additional protection required

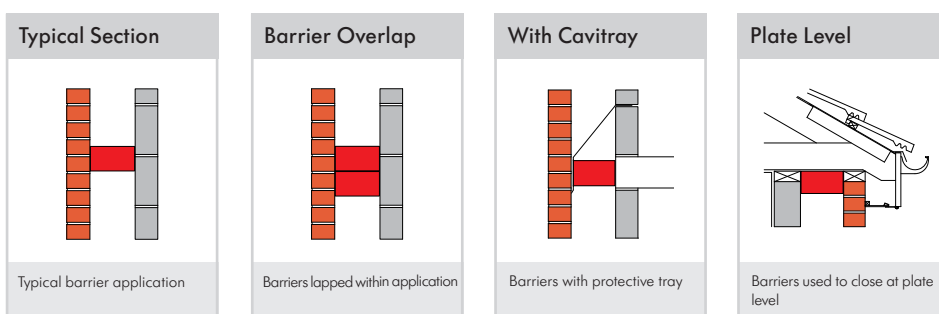
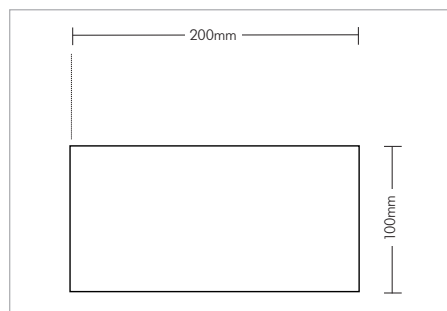

COMPUTER REFERENCE CODES: CAVI 60 MWR 20

DESIGNERS' COMMENTS

Extensively used at plate level to provide cost effective closing with sound and fire barrier qualities. Establishes one hour fire rated protective separation between cavity and roof space.

Every building that is divided into more than one area of different occupation must be designed and constructed in such a way that in the event of an outbreak of fire within the building, fire and smoke are inhibited from spreading beyond the area of occupation where the fire originated. 2.2 BR(S) – mandatory

Fire rated closers tested in a cavity wall consisting of two masonry skins. Where use is proposed where one skin is not of masonry, it is the users responsibility to ensure the proposed construction provides a level of stability, integration, performance and fire resistance and the resultant detail is fit for purpose and will perform to the standard created and determined by the user.

PRODUCT NAME - GROUP

Cavi 60 MWR 200

EXPOSURE RATING

Very severe

CAVITY - STANDARD SIZES ACCOMMODATED

Up to 200mm maximum

SPECIAL CAVITY WIDTHS ACCOMMODATED

Yes – State actual cavity dimension

COMMON CAVITY WALL APPLICATIONS

Yes – build in cavichex as illustrated

CORNERS AND LINKS

Lap and butt options

PRODUCT SIZES

1.2m x 200 x 100mm max.

PROTECTIVE SLEEVING

Yes

ACTS AS INSULATOR

Yes – acts as thermal & fire barrier – see below

INSTALLED AS WALL IS RAISED

Yes – compresses for optimum fit in cured masonry

TRADITIONAL CONSTRUCTION

Fire rated closers tested in a cavity wall consisting of two masonry skins

MASONRY SKIN STYLES

Accommodate most types of finish to either skin

ACOUSTIC INSULATOR

Yes – reduces direct and flanking transmission

FIRE RATED

Yes Prefix denotes 60 mins (1 hr) fire rating

HORIZONTAL AND VERTICAL APPLICATIONS

Yes – horizontal and vertical uses

COMPATIBLE WITH OTHER CAVITY WALL ELEMENTS

Yes – DPC cavity tray and caviweep compatible

SECURING TIES SUPPLIED

N/A. Friction fit + naturally occurring traditional ties

PACK SIZES

Packs contain 10 lengths

WEIGHT PER PACK

10kg

MATERIAL

Rock wool insulator within polysleeve

COLOUR

RED

BUILDING REGULATIONS

Yes regulations can be satisfied

NHBC

Yes requirements can be satisfied

'K' VALUE OF INSULATION USED

0.035W/mK

CFC FREE

Yes + zero ODP

CAD DRAWING DOWNLOADS AVAILABLE

Yes

